

Introducing the **TR—** **Tough Rivet**

Features and Benefits

- Made from a Super Tough Impact Modified UL94 HB Nylon 6/6 in black color
- Rivets are supplied pre-assembled and are easily installed by hand
- Fasten two or more materials together, mounts components or fan guards, or they can also mount other hardware into position
- Replaces the use of screw-nut assemblies or other mounting options

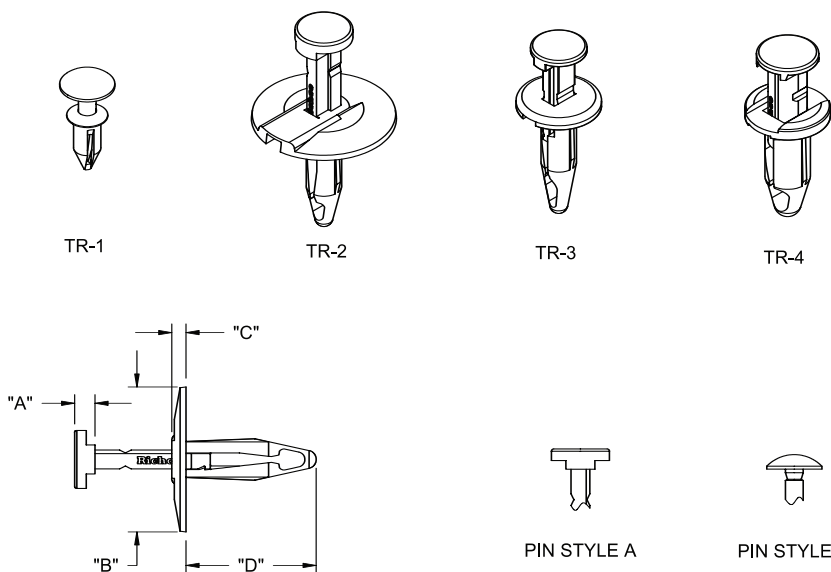
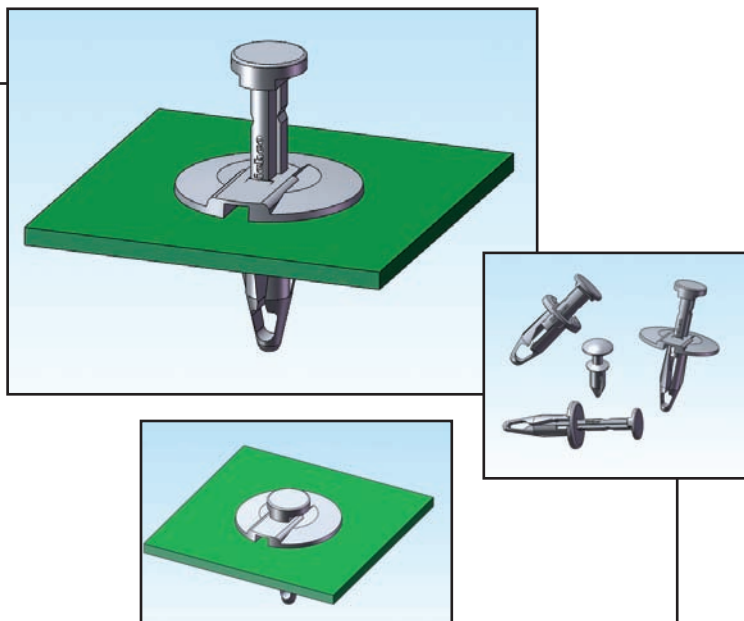

Markets

- Automotive
- Fans & Blowers
- Consumer Electronics
- Brown Goods
- White Goods
- Gaming & Vending Machines

Other Related Richco Product Solutions

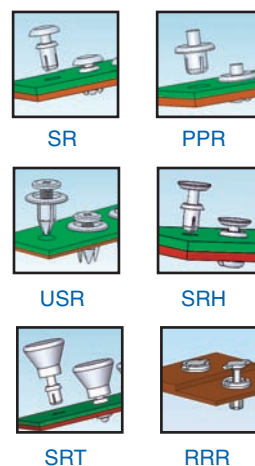

Material: Super Tough Impact Modified Nylon 6/6, RMS-73 Color: Black						Standard Pack: 1,000 per bag		
Part Number	Hole Diameter	Panel Thickness	"A"	"B"	"C"	"D"	No. of Legs	Pin Head Style
TR-1	4.9 - 5.2	1.5 - 4.6	2.5	7.2	1.1	11.3	3	B
TR-2	6.3 - 7	2.5 - 8.9	3.6	25.4	2.5	22.8	2	A
TR-3	6.4 - 7	2.5 - 8	2.8	15	2			
TR-4	8 - 8.3	3-8	2.3		2.7	21.1		

FOR FURTHER INFORMATION AND FREE SAMPLES PLEASE CONTACT YOUR LOCAL RICHCO OFFICE



Richco UK (Int'l HQ)	Tel: (44) 1474 327527	Richco France	Tel: (33) 47208 7140
Richco Benelux	Tel: (31) 334556262	Richco Spain	Tel: (34) 90222 2250
Richco Germany	Tel: (49) 8171 43280	Richco Italy	Tel: (39) 051 6325 266
Richco Finland	Tel: (358) 925221500	Richco Sweden	Tel: (46) 845 99800

PART NUMBER	HOLE DIAMETER	PANEL RANGE	"A"	"B"	"C"	"D"	NO. OF LEGS	PIN STYLE
TR-1	.193-.205 [4.9-5.2]	.059-.181 [1.5-4.6]	.100 [2.5]	.283 [7.2]	.045 [1.1]	.445 [11.3]	3	B
TR-2	.248-.276 [6.3-7.0]	.098-.350 [2.5-8.9]	.140 [3.6]	1.000 [25.4]	.098 [2.5]	.898 [22.8]	2	A
TR-3	.250-.276 [6.4-7.0]	.098-.315 [2.5-8.0]	.110 [2.8]	.590 [15.0]	.079 [2.0]	.897 [22.8]		
TR-4	.315-.325 [8.0-8.3]	.118-.315 [3.0-8.0]	.091 [2.3]	.590 [15.0]	.106 [2.7]	.830 [21.1]		

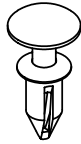

TR-1

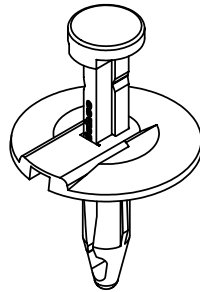

TR-2

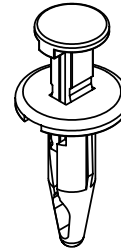

TR-3

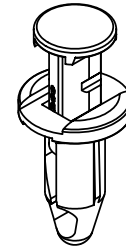

TR-4

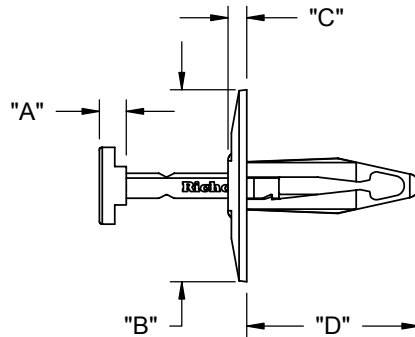

PIN STYLE A



PIN STYLE B

NOTES:

1. MATERIAL: NYLON 6/6, IMPACT MODIFIED (RMS-73).
2. COLOR: BLACK
3. ALTERNATE UNITS FOR REFERENCE ONLY.

REV.	DESCRIPTION	ENGR.	DATE	TITLE:	TOUGH RIVET					DWG IN IN [MM]	
				CREATED USING SOLIDWORKS	FILE #: US07-0137	DWN: R.D.G.	APP: -	PRELIMINARY			
				TOLERANCES UNLESS NOTED XX=±.010 .XXX=±.005 FRAC.=±1/64 ANG.=±1°	SHEET: 1 OF 1	SHEET SIZE: A	DT: 03/09/06	CHKD: -	PART #	PRINT TYPE	
				RE: RICHCO, INC. --	RICHCO, INC. ENG@RICHCO-INC.COM (773) 539-4060			SEE TABLE		CA	